

HARDI PUMP 321



General specifications

- Compact two diaphragm positive displacement pump.
- Supplied with base plate.
- Self-priming.
- Can be run dry.
- Can rotate clockwise or anticlockwise.
- Single grease point for lubrication.
- Dry sump to simplify maintenance.
- No special tools needed for maintenance.
- Polyurethane diaphragms and seals.
- Cast iron crankcase and covers.
- 3/4" suction port, 3/4" pressure port.
- Recommended to use HARDI suction and pressure dampers.

321/3.0 (Ref. no. 821561)

- Cylindrical shaft, 30 mm / 1.18", for combustion and electric engine use.
- Normal operating revolutions, 800 r/min.
- Maximum pressure, 25 bar / 367 PSI.
- Maximum vacuum, 0.82 bar / 12.0 PSI.
- Weight, 23.9 kg / 53 lb.

321/7.0 (Ref. no. 821560)

- Tapered and cylindrical shaft for tractor use with HARDI transmission shaft.
- Normal operating revolutions, 540 r/min.
- Maximum pressure, 25 bar / 367 PSI.
- Maximum vacuum, 0.82 bar / 12.0 PSI.
- Weight, 24.2kg / 53 lb.

321/7.0 (Ref. no. 821557)

- Tapered shaft for tractor use with HARDI transmission shaft.
- Normal operating revolutions, 540 r/min.
- Maximum pressure, 25 bar / 367 PSI.
- Maximum vacuum, 0.82 bar / 12.0 PSI.
- Weight, 23.6 kg / 52 lb.



321/7.0 with pressure and suction damper

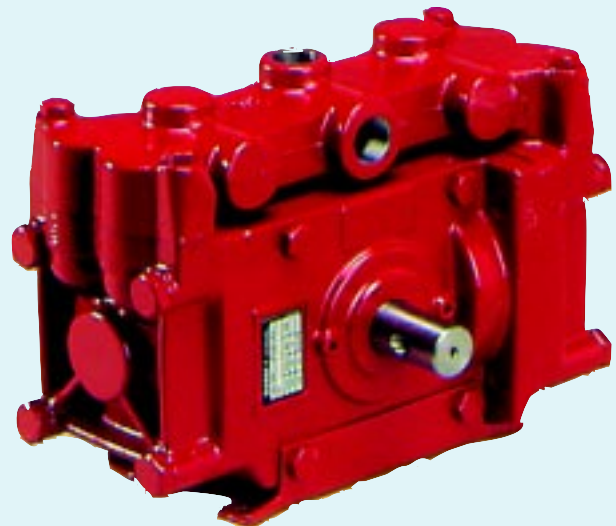

321 pump

821561

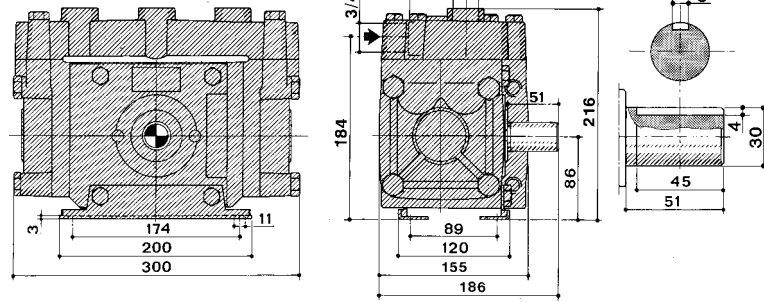

821557

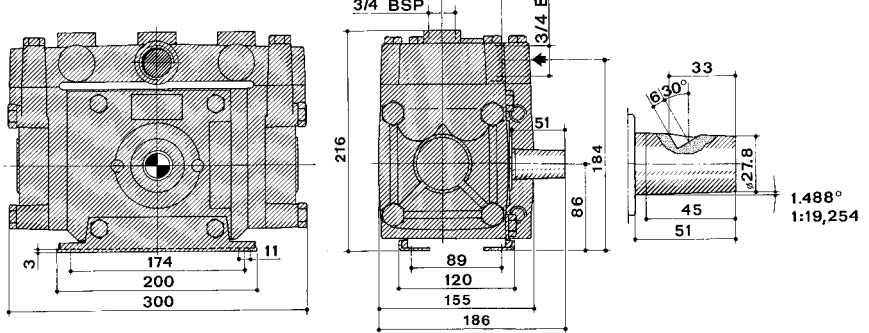

821560

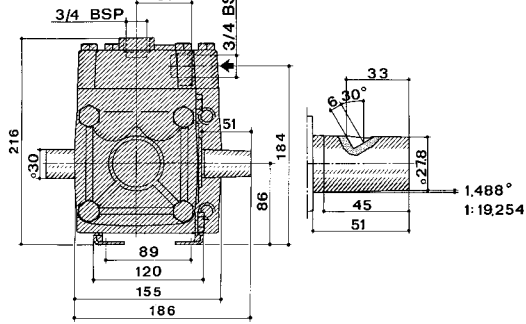

mm to in = mm x 0.0394

	r/min		300		400		500		540		600		700		800		900		1000		
	bar	l/min	kW	l/min	kW	l/min	kW	l/min	kW	l/min	kW	l/min	kW	l/min	kW	l/min	kW	l/min	kW		
321/3.0	0	11	0.1	14	0.2	18	0.2					22	0.3	26	0.4	29	0.5	32	0.6	37	0.7
	2	10	0.1	13	0.2	17	0.3					20	0.4	24	0.5	27	0.6	30	0.7	34	0.8
	4	10	0.2	13	0.3	16	0.4					20	0.5	23	0.6	26	0.7	29	0.8	32	1.0
	6	10	0.2	13	0.4	16	0.5					19	0.6	22	0.7	25	0.8	28	1.0	31	1.2
	10	9	0.4	12	0.5	15	0.6					18	0.8	21	1.0	24	1.1	27	1.3	30	1.5
	15	9	0.5	12	0.6	15	0.8					17	1.1	20	1.3	23	1.4	26	1.6	28	1.8
	20	8	0.7	11	0.8	14	1.1					17	1.4	19	1.6	22	1.8	24	2.0	27	2.2
	25	8	1.0	10	1.1	13	1.4					16	1.6	18	1.8	21	2.0	23	2.3	26	2.5
	PSI	gpm	hp	gpm	hp	gpm	hp					gpm	hp	gpm	hp	gpm	hp	gpm	hp	gpm	hp
	0	2.9	0.1	3.7	0.3	4.8	0.3					5.8	0.4	6.9	0.5	7.7	0.7	8.4	0.8	9.8	0.9
	29	2.6	0.1	3.4	0.3	4.5	0.4					5.3	0.5	6.3	0.7	7.1	0.8	7.9	0.9	9.0	1.1
	58	2.6	0.3	3.4	0.4	4.2	0.5					5.3	0.7	6.1	0.8	6.9	0.9	7.7	1.1	8.4	1.3
	88	2.6	0.3	3.4	0.5	4.2	0.7					5.0	0.8	5.8	0.9	6.6	1.1	7.4	1.3	8.2	1.6
147	2.4	0.5	3.2	0.7	4.0	0.8					4.8	1.1	5.5	1.3	6.3	1.5	7.1	1.7	7.9	2.0	
220	2.4	0.7	3.2	0.8	4.0	1.1					4.5	1.5	5.3	1.7	6.1	1.9	6.9	2.1	7.4	2.4	
294	2.1	0.9	2.9	1.1	3.7	1.5					4.5	1.9	5.0	2.1	5.8	2.4	6.3	2.7	7.1	3.0	
367	2.1	1.3	2.6	1.5	3.4	1.9					4.2	2.1	4.8	2.4	5.5	2.7	6.1	3.1	6.9	3.4	
321/7.0	bar	l/min	kW	l/min	kW	l/min	kW	l/min	kW	l/min	kW	l/min	kW								
	0	26	0.2	36	0.3	45	0.4	48	0.5	54	0.6	62	0.7								
	2	25	0.3	33	0.4	42	0.6	45	0.7	50	0.8	57	1.0								
	4	24	0.4	32	0.6	41	0.8	44	0.9	48	1.1	55	1.3								
	6	24	0.6	32	0.8	40	1.1	43	1.2	47	1.4	54	1.6								
	10	23	1.0	31	1.2	39	1.6	42	1.7	47	1.9	53	2.2								
	15	23	1.5	31	2.0	38	2.2	41	2.3	46	2.5	52	3.0								
	20	22	2.3	30	2.6	38	3.2	41	3.2	45	3.4	50	3.7								
	25	22	3.0	30	3.3	37	3.6	40	4.0	44	4.3	50	4.8								
	PSI	gpm	hp	gpm	hp	gpm	hp	gpm	hp	gpm	hp	gpm	hp								
	0	6.9	0.3	9.5	0.4	11.9	0.5	12.7	0.7	14.3	0.8	16.4	0.9								
	29	6.6	0.4	8.7	0.5	11.1	0.8	11.9	0.9	13.2	1.1	15.0	1.3								
	58	6.3	0.5	8.4	0.8	10.8	1.1	11.6	1.2	12.7	1.5	14.5	1.7								
88	6.3	0.8	8.4	1.1	10.6	1.5	11.4	1.6	12.4	1.9	14.3	2.1									
147	6.1	1.3	8.2	1.6	10.3	2.1	11.1	2.3	12.4	2.5	14.0	3.0									
220	6.1	2.0	8.2	2.7	10.0	3.0	10.8	3.1	12.1	3.4	13.7	4.0									
294	5.8	3.1	7.9	3.5	10.0	4.3	10.8	4.3	11.9	4.6	13.2	5.0									
367	5.8	4.0	7.9	4.4	9.8	4.8	10.6	5.4	11.6	5.8	13.2	6.4									

Model/stroke
r/min
Bar / PSI
kW / Hp
l/min / gpm

Pump model and pump stroke in millimetre.
Maximum revolutions per minute is indicated by the highest figure.
Maximum pressure is indicated by the highest figure.
Power consumption in kilowatt and horsepower.
Capacity in litres and US gallons per minute at zero suction lift.

HARDI INTERNATIONAL A/S
HELGESHØJ ALLE 38 • DK 2630 TAASTRUP • DENMARK
E-Mail: hardi@hardi-International.com • www.hardi-International.com

GB.890681.01.00

HARDI INTERNATIONAL A/S reserves the right to change the specifications without notice.